





## Function of 2.4G remote control

Insert 2 x AAA batteries (Not supplied).

-  Turn ON/OFF manually, functional both for day and night.
- AUTO** Set to turn ON at dusk, Turn off at dawn automatically.
-  Set 4 different levels of brightness
- TEST** Test mode. Light will turn ON and operate for 1min and turn OFF
-  Set light to operate at 100% power when microwave sensor is triggered.
-  Set light to operate at 100% from 30% output when microwave sensor is triggered.
- 4H 6H 12H** Set the light to operate at 100% output for different time period



Battery Capacity Indicator

## Wiring Connection Diagram

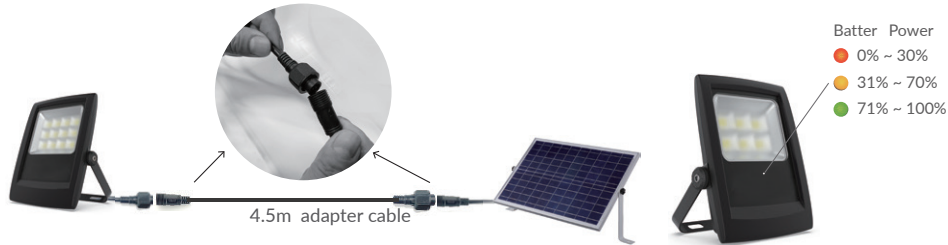

## You can use it for



- Construction Sites
- Car Parks
- Farm Buildings
- Forecourts



## Remark

1. Brightness level of the flood light must be set before choosing operational times (4h, 6h or 12 hours)
2. Motion sensor option is unavailable when setting a specific lighting output (25%, 50%, 75% or 100%)
3. The two motion sensor modes are factory set and cannot be changed. Light will only turn on with 100% output or change from 30% to 100% output when movement is detected by microwave sensor. Only the working time can be adjusted
4. The light will blink twice when it receives the signal successfully from the remote.
5. Light can turn on with ON/OFF button both at daytime and nighttime by manual operation

# NexSun<sup>2500</sup>

## User Manual

## Solar Powered Solar LED Flood Light



\*\*\*\*\*The led light source is non-user replaceable\*\*\*\*\*



## Before Installation

We recommend you always try to install this solar floodlight a place where the solar panel is exposed to direct sunlight in order to achieve maximum performance. The working time of the solar flood light is directly related to the solar panels exposure to sunlight. Performance will be affected by weather and season. The performance of the solar flood light will be directly effected by multiple days of insufficient sunlight. In this situation we recommend the power output be reduced to 50% or 25% of full output to ensure constant dusk to dawn lighting. The solar panel must be exposed to sunlight ,do not install light under trees. Remove any debris from the solar panel and clean occasionally with soap and water.

Do not install your solar floodlight where the solar panel is exposed to ambient light from a street light or Porchlight. If the inbuilt photocell within the solar panel detects light from another source it may not operate it Unlike most solar lighting that will not operate when the solar panel is exposed to sunlight, we have installed a custom program that allows you to use the remote to turn on the floodlight freely regardless of external light conditions. With this function, it makes this light perfect to be used for the places that require lighting in day time, like the basement, warehouse etc, Light can work both at daytime as well as nighttime with manual operation. no more darkness with this solar flood light.

## Main Specification

Model	NEXSUN-2500
Luminous flux	2500lm
Battery capacity	6.4V 115WH
Solar panel	10V 35W
Remote control	2.4G
Motion sensor	microwave
Connection cable	4.5 meters totally from luminaire to solarpanel totally.



**Safe disposal of waste electrical products, batteries**  
If at any time, you need to dispose of this product or parts of this product: please note that waste electrical products, batteries should not be disposed of with ordinary household waste. Recycle where facilities exist. Check with your local authority for recycling advice. Alternatively, NightSearcher is happy to take receipt of this product at end-of-life and will recycle it on your behalf.

## Materials in Package



01 : Solar flood light ( 1pc )



02 : Solar Panel ( 1pc )



03 : Remote control ( 1pc )



04 : Expansion screw ( 4pcs )



05 : 4.5m Adaptor cable (1pc)



06 : Brackets ( 2pcs )



User manual ( 1pc )



All NightSearcher products have a 3-year standard warranty on all manufacturing defects .  
**Extended Warranty:** You have the option to extend the warranty of the product to 5 years for manufacturing defects. Registration of the product must be made within one month of purchase by sending us an email [sales@nightsearcher.co.uk](mailto:sales@nightsearcher.co.uk). In the message please state in your own words that you would like to register your NightSearcher product for the extended warranty. To view NightSearcher's warranty policy, please visit: <http://nightsearcher.com/en/warranty.html> or scan the QR code.  
NightSearcher Limited - Unit 4 Applied House, Fitzherbert Spur, Farlington, Portsmouth, Hampshire PO6 1TT UK.



1. Measure the holes from the light bracket and make two marks to drill.

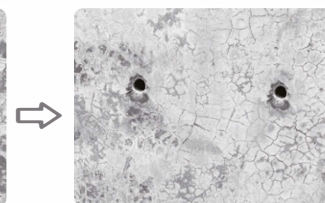

2. Drill 2 holes with an M10 drill bit on the surface according to the two marks.



3. Place the expansion screw into the hole.



4. Remove the shrapnel, washer, and the nut from screws.



5. Place the light bracket over the fixings.

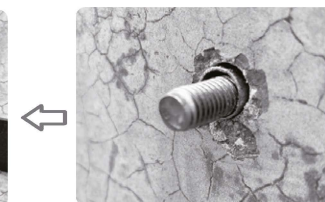

6. Place the light bracket over the fixings, replace washers.



7. Tighten the two nuts with wrench.



8. Install the flood light and adjust the light direction as needed. Tighten the fixings.



9. Assemble the solar panel bracket with the black fixings as picture shows.



10. Install the solar panels in the location, and make sure solar panel is exposed to full sunlight.

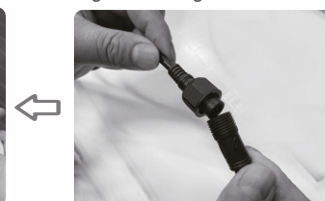

11. Connect the adapter cable between the solar floodlight and the solar panel. Insure that this waterproof connection is secured



12. Use the supplied remote control to operate the solar flood light as previously instructed.

## Common trouble shot

PROBLEM	POSITION	HOW TO SOLVE
Light is off	Switch is off	Push on the switch
	No direct sun	Move light to sunshine place
	Much cloudy or rainy days	Work again when sun comes
Short working time	Debris on solar panel	Clean solar panel
	Installation location	Adjust location
	Cloudy or very rainy	Work again when sun comes
	Battery life is expried	Replace the battery in remote
	Remote setting is wrong	Press the longer time button.